

# **PENTAIR HAFFMANS TOTAL LAB SOLUTION**

# ***LAB SOLUTIONS***

---

**Lab Solutions (LS) is a concept successfully implemented by Pentair Haffmans to build a new laboratory.**

## **Why Lab Solutions from Haffmans?**

- Properly locating & designing of various laboratory rooms for ease & efficient handling of raw materials, samples, chemicals & instruments.
- Expert solution from Haffmans to complete your entire lab requirement which includes Haffmans, non Haffmans equipment and lab furniture.
- Carefully designed training & tasting room in accordance with the customer's requirement
- Proper training on operation & maintenance.

# Pentair Haffmans LS Advantages

---

- Brand Image
- Cost savings
- Efficient project management
- No requirement of Internal Project Management
- Single Partner for Entire Project - Simplification of multiple vendors
- Assured quality products
- Single point contact for after sales service/warranty

**ONE STOP SHOP FOR LAB NEEDS**

# Overview of Laboratory configuration

---

1. Sample preparation room
2. Microbiological Lab – I
3. Microbiological Lab – II
4. Analytical & Instrumentation lab
5. Hot room
6. Chemical & Sample storage  
and also
  - Taste Room
  - Training room
  - Manager Cabin

# TYPICAL LAB LAYOUT

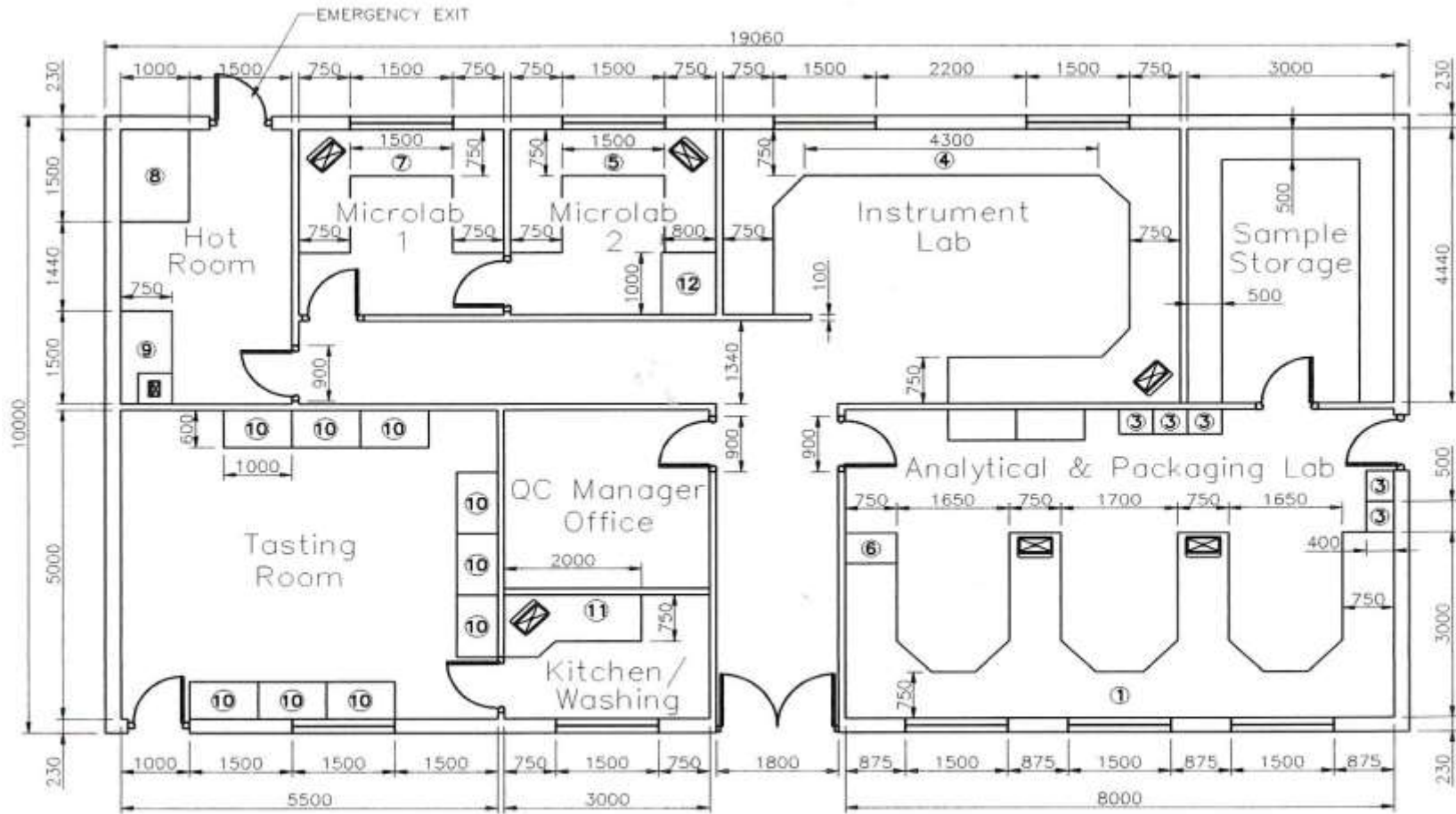

LAY-OUT IS PROVISIONAL, INDICATIVE ONLY AND SUBJECT TO DETAILED ENGINEERING

# Equipment in TLS

---

**Total Lab Solution – Turnkey Package”** includes the Imported Components, local sourced components and Lab Modular Furniture being offered completely in Indian Rupees. All Indian manufactured equipment has been carefully selected & Quality Controlled by Pentair Haffmans.

- Haffmans BV The Netherlands containing all European made equipment and provided services.
- QC Equipments Indian & Imported.
- Laboratory Furniture with a Taste Room.